



Automotive HDMI Type E Connector

CONNECTOR

MB-0242-1

February 2012

MX50/53 Series

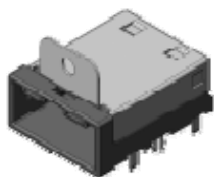
Receptacle ConnectorPlug ConnectorType A Relay Connector

Recently for car interiors, the demand for entertainment devices such as blu-ray players and connectivity with digital portable devices like smartphones has been increasing. To meet this demand, JAE has now developed the MX50/53 Series connector compatible with the HDMI Type E connector standard for automotive applications.

The MX50/53 Series connector was designed to satisfy high-speed transmission performance while taking into account automotive use requirements, and it achieves both mechanical and environment suitability through features such as exclusively developed shielded wires.

**HDMI: High-Definition Multimedia Interface, trademark of HDMI Licensing, LLC.

Features

- 1.5mm horizontal pitch, 2-row, 19 position.
- Impedance matching design, compatible with high-speed transmission.
- Mechanical lock to resist twisting in the mated connector.
- HDMI Type A relay product is also available.
- Supplied as a harness product to ensure transmission performance reliability.

General Specifications

- Number of Contacts: 19 position
- Contact Resistance: Contact area, 30mΩmax.; Shell area, 50mΩmax. (change from initial)
- Rated Voltage: AC500V (un-mated)
- Operating Temperature: -40 Deg. C to +85 Deg. C
- Rated Current: 0.5A per terminal
- Insulation Resistance: 100MΩmin. (un-mated)
- Applicable Board Thickness: 1.6mm
- Applicable Wire: Shielded twist pair wire (for harness)

Materials and Finishes

■ Receptacle Connector

Component	Material / Finish
Pin Contact	Brass / Contact area: Au plating Terminal area: Sn plating
Housing	30%GF SPS, other
Shell	Copper alloy / Sn plating, other

■ Plug Connector

Component	Material / Finish
Socket Contact	Brass / Contact area: Au plating Terminal area: Sn plating
Housing	PBT, other
Shell	Copper alloy / Sn plating, others

■ Type A Relay Connector

Component	Material / Finish
Pin Contact	Copper alloy / Contact area: Au plating Contact area: Au plating
Housing	PBT, other
Shell	Copper alloy / Sn plating, other



■ Plug Connector (for reference)

Unit: mm

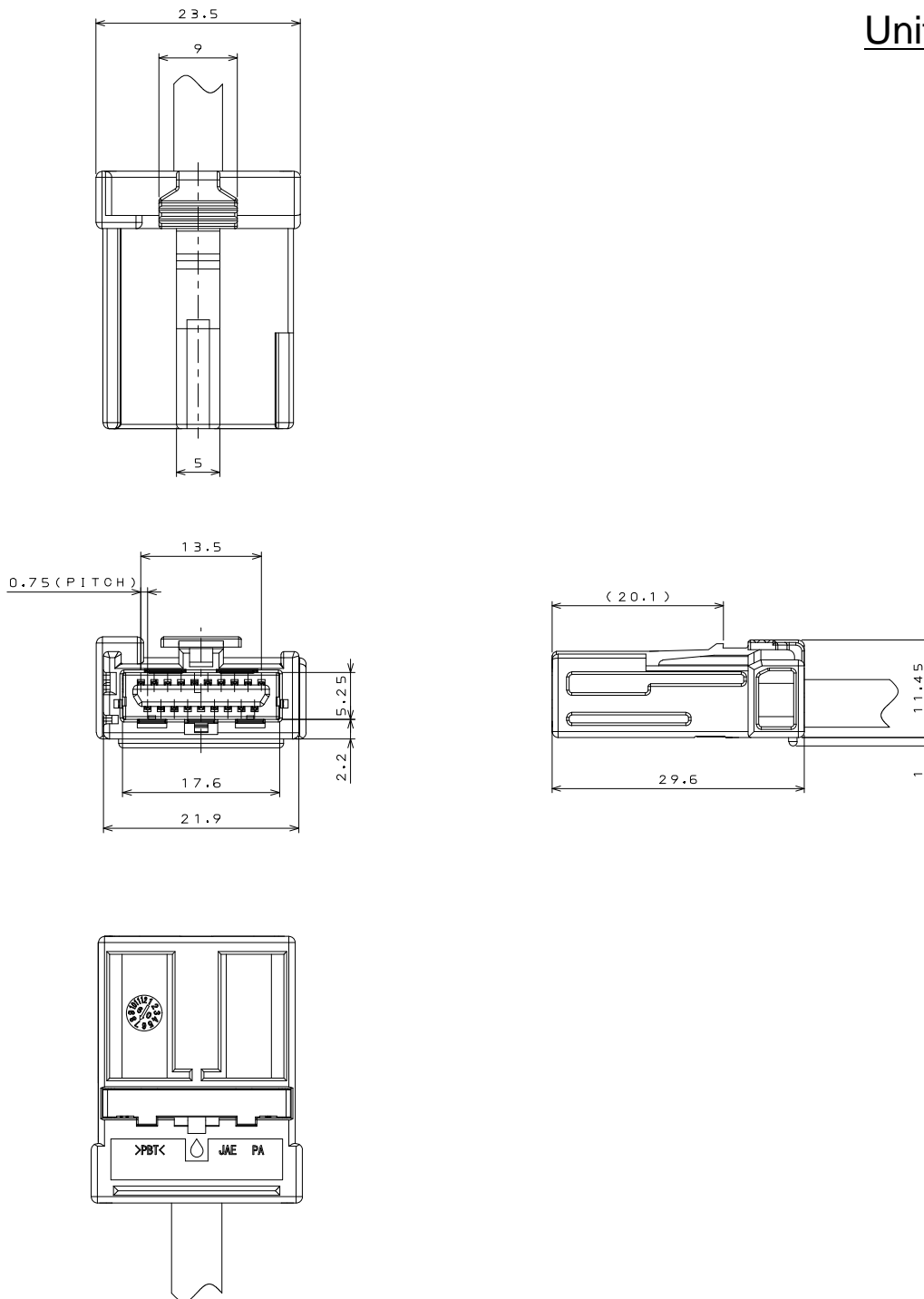

Note: Plug Connector is a harness product.
It is not sold as an individual connector.

■ Type A Relay Connector (for reference)

Unit: mm

Note :

Type A Relay Connector is a harness product.

It is not sold as an individual connector.

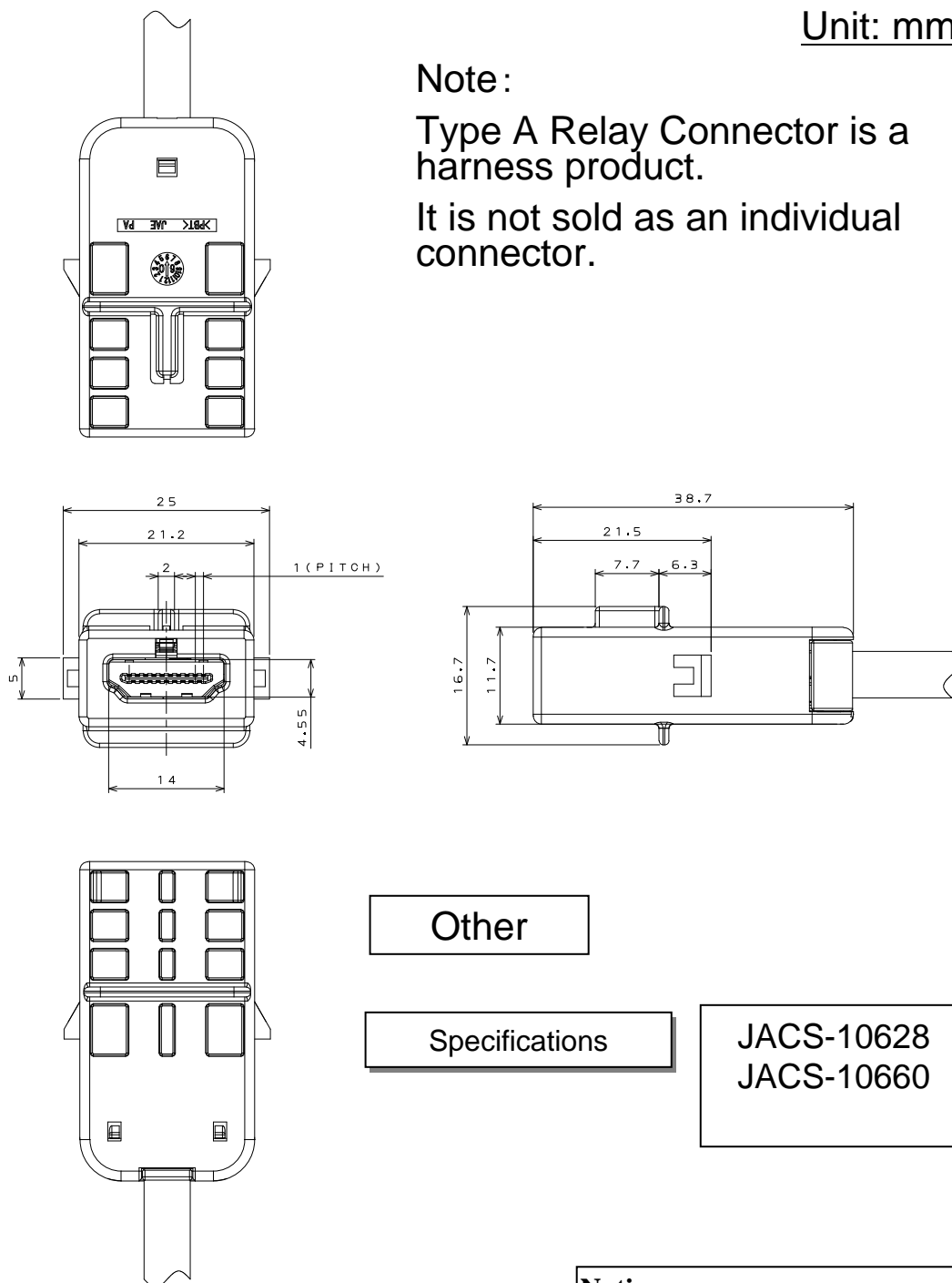

Other

Specifications

JACS-10628
JACS-10660

Notice: Products shown in this brochure are made for the applications listed below. However, if the above-mentioned products are to be used in aerospace devices, marine cable-connection devices, atomic power control systems, medical equipment for life-support systems, or any other specific application requiring extremely high reliability, please contact JAE for further information.

Recommended applications: Computers, Office machines, Measuring devices, Telecommunication devices (Terminals, Mobile devices), AV devices, Household applications, FA devices, etc.

Japan Aviation Electronics Industry, Limited

Product Marketing Division

Aobadai Building, 3-1-19, Aobadai, Meguro-ku, Tokyo 153-8539

Phone: +81-3-3780-2787 FAX: +81-3-3780-2946

* The specifications in this brochure are subject to change without notice. Please contact JAE for information.

Mouser Electronics

Authorized Distributor

Click to View Pricing, Inventory, Delivery & Lifecycle Information:

[JAE Electronics:](#)

[MX50019NQ1](#)