

Standard



*Image for illustrative purpose only*

## Summary

[Request a quote](#)

SE series

---

Size	3S
Series	S - Indoor Stepped Insert

[https://www.lemo.com/int\\_en/solutions/originals/s-indoor-stepped-insert/gra-3s-269-gn.html](https://www.lemo.com/int_en/solutions/originals/s-indoor-stepped-insert/gra-3s-269-gn.html)

LEMO products and services are provided "as is". LEMO makes no warranties or representations with regard to LEMO product & services or use of them, express, implied or statutory, including for accuracy, completeness, or security. The user is fully responsible for his products and applications using LEMO components.

# Technical details

## Form & Material

Shell style / Model id	GRA - Insulating washer
Housing material	Polyamide, black
Keying	No keying
Weight	0.44 g

## Environment

Technical domain	Audio Video, Energy and Industrial, Semiconductor, Test and Measurement
Environmental sealing (IP rating)	No IP rating
Temperature range	-40°C / +90°C
Climatic Category	55/175/21
Humidity (max)	<=95% [at 60 deg C /140 F]
Shielding (min)	75 dB (10 MHz)
Shielding (min)	40 dB (1 GHz)
Shock Resistance	100 g [ 6 ms]
Vibration	15 g [10 Hz - 2000 Hz]

## Drawings

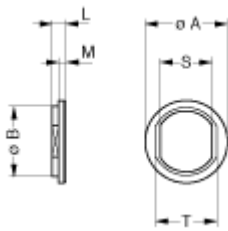

No keying

## Dimensions

	A	B	L	M	S	T
mm.	25	21.8	2.2	1.2	16.7	20.2
in.	0.98	0.86	0.09	0.05	0.66	0.8

[https://www.lemo.com/int\\_en/solutions/originals/s-indoor-stepped-insert/gra-3s-269-gn.html](https://www.lemo.com/int_en/solutions/originals/s-indoor-stepped-insert/gra-3s-269-gn.html)

LEMO products and services are provided "as is". LEMO makes no warranties or representations with regard to LEMO product & services or use of them, express, implied or statutory, including for accuracy, completeness, or security. The user is fully responsible for his products and applications using LEMO components.